

# OptiM8 RT36C and RT60C Commercial Series

## Adaptable Broadcast Spreader

### Assembly and Operating Instructions



**PLEASE CONTACT US:** IF YOU ARE MISSING ANY PARTS, HAVE ANY DIFFICULTY IN ASSEMBLY, OR HAVE ANY QUESTIONS REGARDING THE SAFE OPERATION OF THIS SPREADER. THIS MODEL INCLUDES LIFETIME TECHNICAL SUPPORT. **SUPPORT HOT LINE: FREEFONE 0800 424 919 – E.mail: sales@rigbytaylor.com**

#### HELPFUL HINTS:

- ☑ If your spreader does not spread evenly, be sure the FRONT on the gear box points to the front of the spreader. The impeller must turn clockwise. Reversing the gearbox will cause the impeller to turn counter clockwise. Clean the impeller after each use as some fertiliser may become stuck on the impeller blades and will cause uneven spreading.
- ☑ Your spreader is designed to be pushed at three miles per hour, which is a brisk walking speed. Slower or faster speeds will change the spread patterns. Wet fertiliser will also change the spread pattern and flow rate.
- ☑ Clean and dry your spreader thoroughly after each use, wash between the shut-off plate and bottom of the hopper regularly. To prevent rust, coat all metal parts (inside and out) including the frame tubes with a light oil, silicon spray, or Fluid Film®.
- ☑ Gears are permanently lubricated at the factory. Do not open the gearbox or dirt may enter.
- ☑ When using **Rock Salt** to prevent damage to the gearbox remove salt from the hopper daily. **Rock Salt** will reconstitute back into a solid block if left in the hopper overnight and will damage your gearbox if pushed with the salt in place.

#### WARNING

Do not use air tools to assemble.  
To prevent seizing coat all bolts with a wax or grease prior to installation.



Remove all parts, hardware, and assemblies from carton and lay them out on the floor to help in assembly.

*Below are tools needed for assembly - 7/16" wrench, ratchet and 7/16" socket, and pliers.*

**The following photos are for assembly purposes, and please follow them from left to right, top to bottom.**





# ASSEMBLY

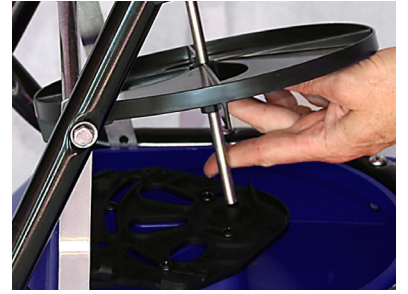



**ASSEMBLY - continued** →

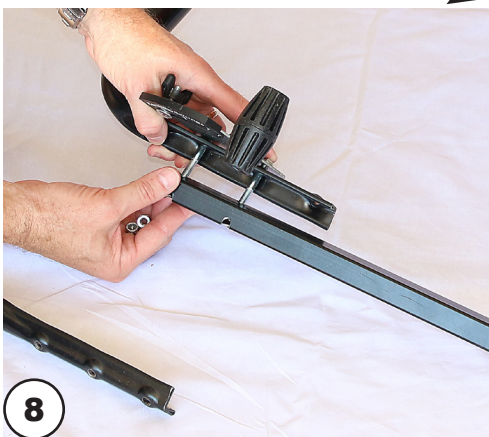



**ASSEMBLY - continued** 

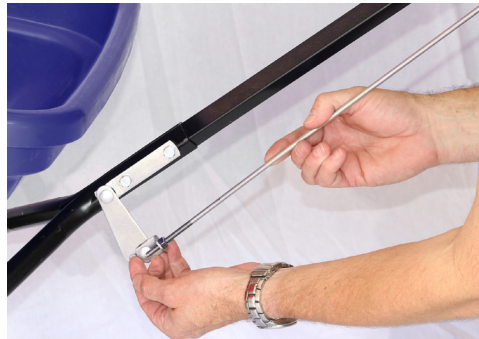



**ASSEMBLY - continued** →

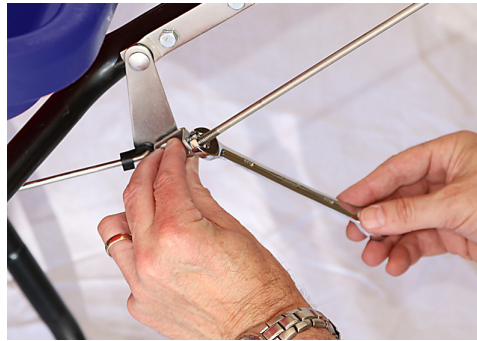

**CONFIRM THE CALIBRATION:**  
Lever at #30 and the drop holes fully open

**COMPLETE ASSEMBLY:**  
Install agitator, bend the agitator up slightly  
to prevent contact with the standard output tray,  
and install debris screen  
(press over 1/4 turn fasteners to secure)

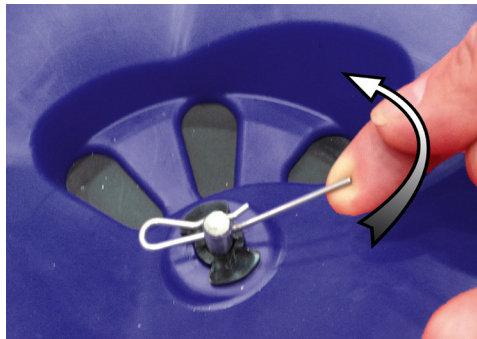



# TRAY INSTALLATION



**HIGH-OUTPUT AND LOW-OUTPUT:**  
require the use of the Part #F12117



**HIGH-OUTPUT AND LOW-OUTPUT:**  
require the use of the Part #F12117





# SPREAD PATH

## FULL Rate (one pass)

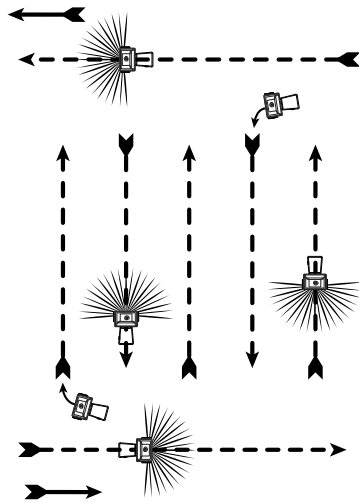

## HALF Rate (two passes)

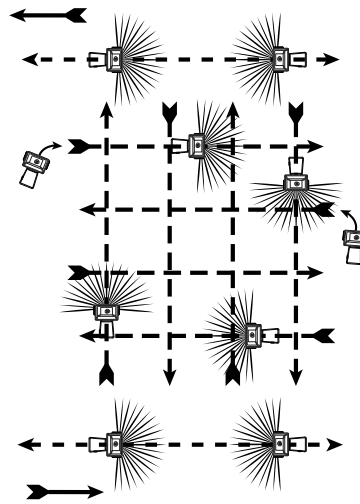

### 5-YEAR LIMITED WARRANTY

Rigby Taylor Ltd (RTL) warrants this product free of defects in original workmanship and materials for a period of 5-Years to the end user with the original purchase receipt. If a manufacturing non-conformance is found, RTL at its discretion will repair or replace the part(s) or product at no charge provided the failure is not the result of incorrect installation, mishandling, misuse, tampering, or normal wear and tear as determined by RTL. RTL at its discretion may require that the part(s) or product be returned along with the original purchase receipt at owners' expense for examination and compliance with the terms of this warranty. Do not return any product without first receiving authorization from RTL. To seek remedy under this warranty, contact RTL at FREEFONE 0800 424 919, or write to Rigby Taylor Ltd, 16 Rivington House, Horwich Loco Estate, Horwich, Lancs BL6 5UE and describe the nature of the manufacturing defect. **SPECIFIC LIMITATIONS:** This warranty covers only the part(s) or product; any labor charges associated with repair or replacement of non-conformances are specifically excluded. Due to the corrosive nature of most fertilisers and ice melt products, RTL makes no warranty against and specifically excludes part(s) or product degradation or failure due to corrosion or its effects. Clean and dry your spreader thoroughly after each use, as a preventative measure, coat all metal parts with a light oil or silicon spray

### OPERATING INSTRUCTIONS

Before filling hopper, become familiar with the operation of this spreader.

- Obtain proper setting for material to be used from the enclosed SETTING MATRIX included with this spreader.
- Move stop bolt on rate gauge assembly to the proper setting.
- While pushing spreader forward, pull control lever back to stop bolt.
- To stop, push lever forward to close flow holes before you stop moving.
- When finished, empty any remaining material from hopper.
- Thoroughly wash spreader and allow to dry before storing. Apply coating of light oil to help prevent corrosion.
- If you use Rock Salt, **remove agitator** when using Rock Salt to prevent damage to the gearbox.

Rigby Taylor Ltd  
16 Rivington House,  
Horwich Loco Estate,  
Horwich, Lancs  
BL6 5UE  
*For Your Records*

\_\_\_\_\_  
*Date Purchased*

\_\_\_\_\_  
*Place of Purchase*

### HOW TO ORDER SPARE PARTS

All spare parts listed may be ordered direct from  
RTL

Be sure to give the following information when ordering.

**Model Number**

**Part Number**

**Part Description**

Call FREEFONE 0800 424 919



# Using the OptiM8 - RT36C and RT60C Models Dual Port PRO Adjustable Shut-Off System

The OptiM8 Dual Port PRO Adjustable Shut-Off System is included on all Commercial models and allows the operator to balance the spread pattern evenly across the full 180° spread width, regardless of the weight or size of granular material. By closing either the right and or left side throwing ports you can balance the spread pattern to exacting precision without compromising spread width or application rate.

Each OptiM8 Dual Port PRO Adjustable Shut-Off System drop hole has a corresponding 1/3rd coverage area on the spread width of the spreader leaving a feathered-edge for overlapping the spread path. The illustration to the right shows each port and the corresponding 1/3rd coverage area of the spread path. These ports can be adjusted to effectively balance the spread pattern, giving equal amounts of material across the full 180° spread pattern.

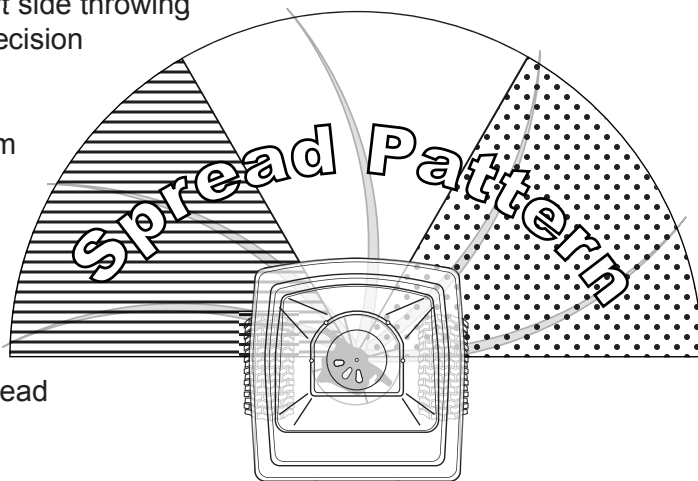

## OptiM8 DUAL PORT PRO SYSTEM SETUP

*Test all material prior to beginning your spreading job. You will need a 20 metre measuring tape, a small scale to weigh the material, bucket or container to hold the material for re-weighing, chalk or a line marking device, and (7) low baking trays.*

*Using the Rigby Taylor Bag Calibrator #77016 can greatly reduce the time needed for determining the Setting Rates on any material but is not mandatory to establish a setting rate.*

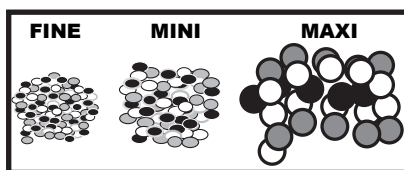
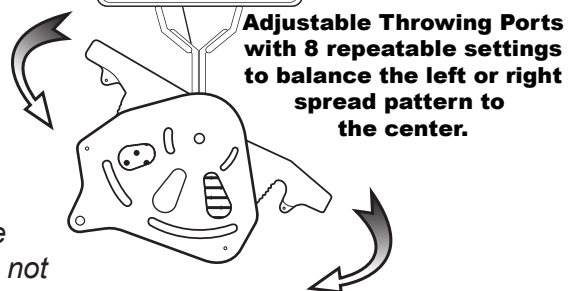

1. Evaluate the material being spread by comparing it to the following standard as a reference.

**Maxi** (3mm / 1/8 in), spread width is 8.5 - 11 metres (28 - 36 feet)

**Mini** (1.5-2mm/1/16th in) spread width is 6.1 - 7.3 metres (20 - 24 feet)

**Fine** (sand grain size), spread width is 4.8 - 5.5 metres (16 - 18 feet)

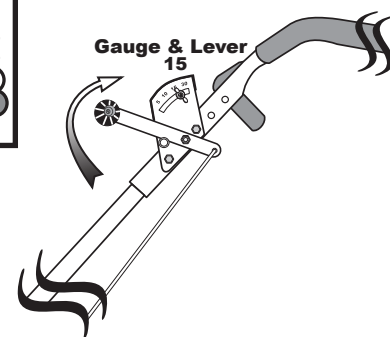

2. Add a small amount of the material into the spreader, enough to cover the bottom (5 - 7 cm / 2-3 inches) and begin to test for spread width. Set the stop on the gauge to #15 and push the spreader several metres/feet at normal walking speed on a flat hard surface (where the material will be visible). **OPEN** the lever to the **STOP** while continuing to walk for 3-4 paces, and **CLOSE** the shut-off and **STOP** (don't move the spreader from that position). Measure the spread width and evaluate the spread pattern for even distribution on either side of the spread width centre-line. **TIP:** Typical spread width references are listed above. *The spread width that you measure is used to calculate the actual Setting Rate for the material.*

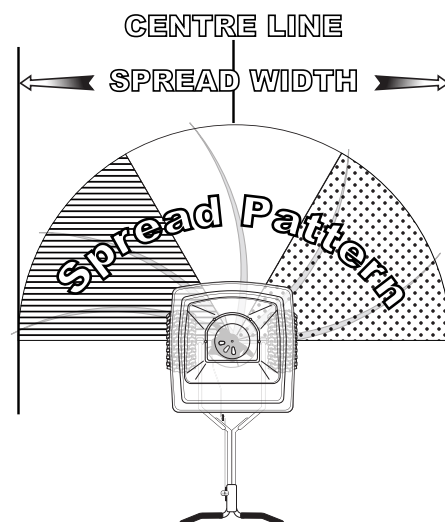



## ADJUSTING THE OptiM8 DUAL PORT SHUT-OFF SYSTEM

3. Next, using the (7) low baking trays. Position them in a straight line on 60cm (2 ft) Centres across the spread width as shown at the right.

Adjust the left or right variable throwing ports to even out the spread pattern.

**TIP:** For large/heavy materials, close the **LEFT SIDE (LINES)** port slightly before you start your OptiM8 test. For small/light materials, open the **LEFT SIDE (LINES)** port fully and close the **RIGHT SIDE (CIRCLES)** port slightly before you start the test. With **BOTH** ports closed, the spread is only from the centre port and will give you a 1 – 1.2 metre (3-4ft) spread width in the centre of the spreader - *great for medians.*

Begin pushing the spreader, at normal speed, 2-3 metres before reaching the first line of baking trays. Walk along the Centre Line, and **OPEN** the Lever to the **STOP** position 3-4 paces before the line of baking trays and continue walking past the baking trays 1 or 2 paces and **CLOSE** the Lever and **STOP**.

Visually evaluate the material in the baking trays to determine if your spread pattern is balanced, *i.e. having the same amount of material in each baking tray.*

Empty each baking tray back into the spreader, adjust the ports and **RETEST** until you are satisfied that the coverage is balanced.

Empty each tin back into the spreader, adjust the ports and **RETEST** until you are satisfied that the coverage is balanced.

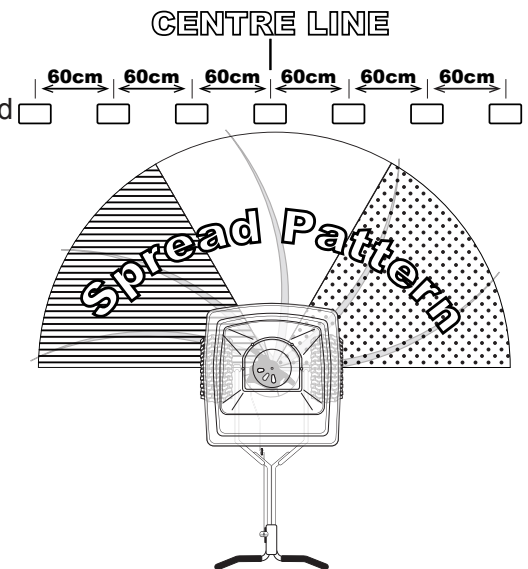
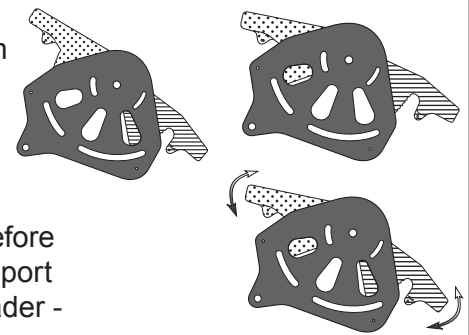

Spread Width Metres	Length needed for 100 Sq. M	Spread Width Metres	Length needed for 100 Sq. M	Spread Width Metres	Length needed for 100 Sq. M
2.1	46.9	5.2	19.3	8.2	12.1
2.4	41	5.5	18.2	8.5	11.7
2.7	36.4	5.8	17.3	8.8	11.3
3	32.8	6.1	16.4	9.1	10.9
3.4	29.8	6.4	15.6	9.5	10.6
3.7	27.3	6.7	14.9	9.8	10.3
4	25.2	7	14.3	10.1	10
4.3	23.4	7.3	13.7	10.4	9.7
4.6	21.9	7.6	13.1	10.7	9.4
4.9	20.5	7.9	12.6	11	9.1

## ESTABLISH THE SETTING RATE

4. Remove the material from the hopper, and mark the distance that you need to travel with the spreader to attain the designated coverage area - *i.e. 300 metres using the spread width you determined earlier. Above is a chart to help determine the distance needed for 300 metre calculation.*

Mark the **START** and **END POINTS** on the surface required for the test.

Weigh a small amount (4-9 kg/10-20lb) of the material, and add that into to the spreader. Using the Setting Matrix included with the spreader, estimate a setting rate based on material manufacturers recommendations and adjust the **STOP** on the Gauge to that position.

To start the test, start walk 1-2 paces before the **START LINE** and **OPEN** the Lever to the stop position and then **CLOSE** when you cross the **END POINT LINE**.

Pour the remaining material from the spreader and weigh to calculate the amount applied over the area. Adjust the **Setting Rate** to a higher number if you need to increase the application rate, or to a lower number if you applied too much in the test.

You may need to repeat this process to acquire the exact rate.

The Dual Port PRO Adjustable Shut-Off System ensures that OptiM8 Commercial spreaders evenly spread all types of fertilisers, seed, ice melt, or other granular products.

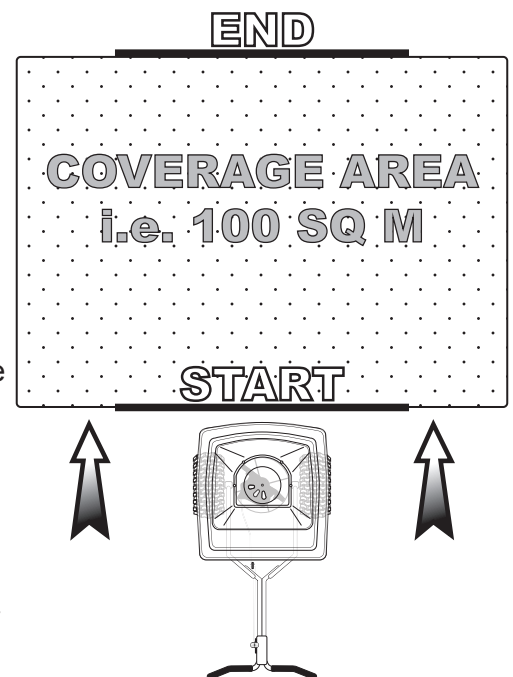



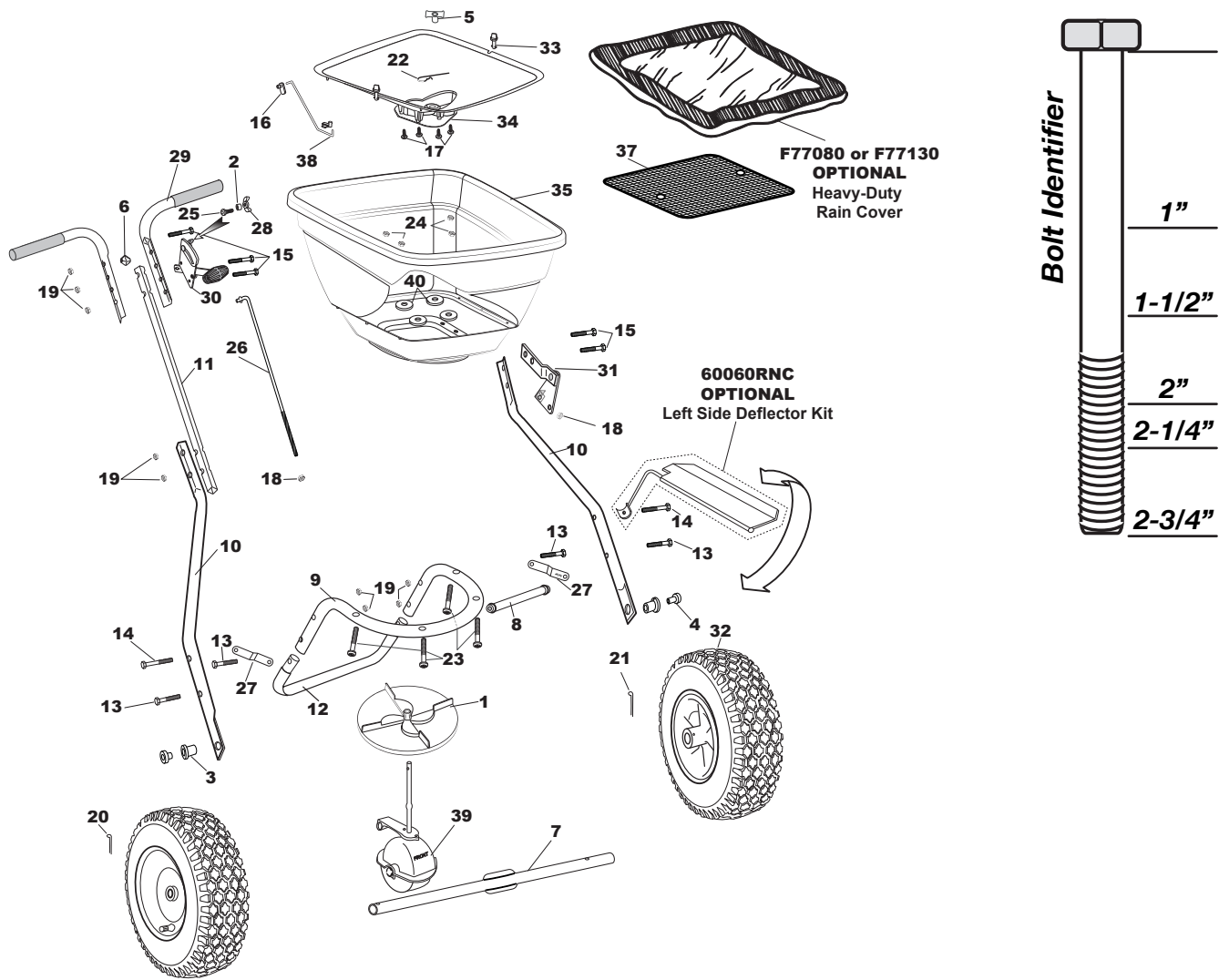

## OptiM8 RT36C & RT60C COMMERCIAL PAINTED BROADCAST SPREADER

Key #	Part #	Description	Key #	Part #	Description
1	12110	IMPELLER 9" ROUND DISHED	23	36214	1/4-20 X 1 1/2" PHPMS S.S.
2	12147	SPACER (PIVOT LINK)	24	36300	1/4-20 NYLON INSERT LOCKNUT S.S.
3	12148	AXLE BEARING	25	37100	1/4-20 X 1" CARRIAGE BOLT ZINC
4	12152	AXLE BUSHING	26	42256	CONTROL ROD
5	12209	HOPPER BUSHING	27	44249	FRAME BRACE
6	12344	HANDLE SPACER	28	60027	WING NUT ASSEMBLY BLACK
7	24500	AXLE	29	60175	UPPER HANDLE SQUARE W/GRIP ea
8	25228	CROSS BRACE 11.25"	30	60298	GAUGE & LEVER ASSEMBLY
9	25108	FRAME	31	60300	PIVOT & BRACKET ASSEMBLY
10	25222	LOWER HANDLE	32	70138	PNEUMATIC DRIVE WHEEL STUD
11	25223	HANDLE SHAFT	33	F12135	1/4 TURN FASTENER
12	25723	FRAME Foot	34	F12219	STANDARD OUTPUT SHUTOFF
13	31100	1/4-20 X 1 1/2 HHMS ZINC	35	F13105RT RT36 HOPPER / F13106RT RT60 HOPPER	
14	31106	1/4-20 X 2 1/4" HHCS ZINC	36	F13130	STANDARD OUTPUT TRAY KIT
15	31120	1/4-20 X 2" HHCS ZINC	37	F40003	SQUARE SCREEN
16	31127	ROD CLIP ( )	38	F44251	PIVOT ROD STD OUTPUT
17	31138	#8 X 3/8" PMT #8 HD COARSE BLACK	39	F60333	GEAR BOX ASSEMBLY
18	32100	1/4-20 HEX NUT ZINC	40	43020	BACKPLATE WASHER (FOR RT60)
19	32103	1/4-20 NYLON INS LOCKNUT ZINC	Optional	60060RNC	SIDE DEFLECTOR
20	33108	3/16" X 1" COTTER PIN ZINC	Optional	HEAVY DUTY RAIN COVER (F77080 for RT36 / F77130 for RT60)	
21	33109	3/16" X 2" COTTER PIN ZINC	Standard	12196RT	GAUGE OVERLAY- RT
22	33117	AGITATOR			

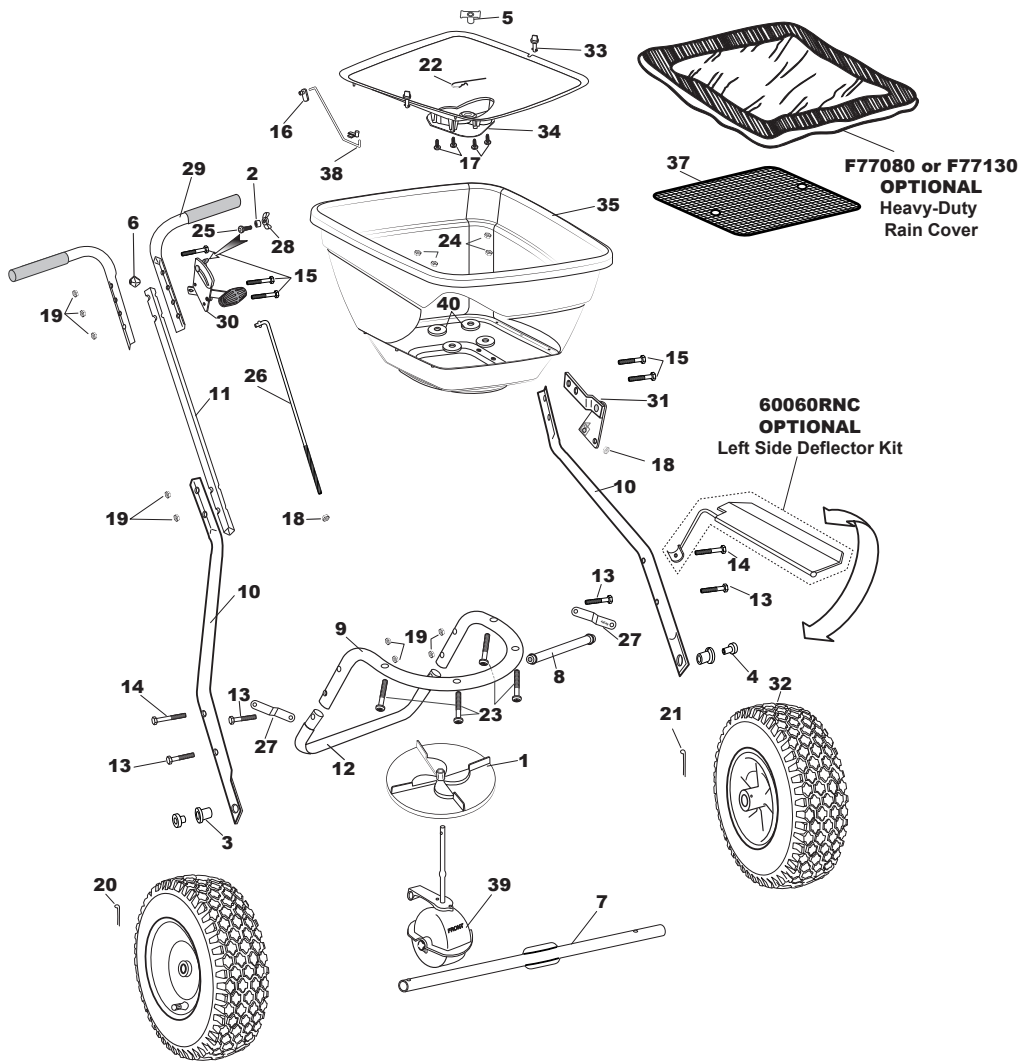

## OptiM8 RT36CS & RT60CS COMMERCIAL STAINLESS STEEL BROADCAST SPREADER

Key #	Part #	Description	Key #	Part #	Description
1	12110	IMPELLER 9" ROUND DISHED	23	36214	1/4-20 X 1 1/2" PHPMS S.S.
2	12147	SPACER (PIVOT LINK)	24	36300	1/4-20 NYLON INSERT LOCKNUT S.S.
3	12148	AXLE BEARING	25	37100	1/4-20 X 1" CARRIAGE BOLT ZINC
4	12152	AXLE BUSHING	26	42256	CONTROL ROD
5	12209	HOPPER BUSHING	27	44249	FRAME BRACE
6	12344	HANDLE SPACER	28	60027	WING NUT ASSEMBLY BLACK
7	24500	AXLE	29	60175-SS	UPPER HANDLE SQUARE STAINLESS W/GRIP ea
8	25228	CROSS BRACE 11.25"	30	60298	GAUGE & LEVER ASSEMBLY
9	24111	FRAME	31	60300	PIVOT & BRACKET ASSEMBLY
10	25222-SS	LOWER HANDLE	32	70138	PNEUMATIC DRIVE WHEEL STUD
11	25223-SS	HANDLE SHAFT	33	F12135	1/4 TURN FASTENER
12	25723-SS	FRAME FOOT SS	34	F12219	STANDARD OUTPUT SHUTOFF
13	36200	1/4-20 X 1 1/2" HHCS S.S.	35	F13105RT RT36 HOPPER / F13106RT RT60 HOPPER	
14	36205	1/4-20 X 2 1/4" HHCS S.S.	36	F13130	STANDARD OUTPUT TRAY KIT
15	36216	1/4-20 X 2" HHCS S.S.	37	F40003	SQUARE SCREEN
16	31127	ROD CLIP ( )	38	F44251	PIVOT ROD STD OUTPUT
17	31138	#8 X 3/8" PMT #8 HD COARSE BLACK	39	F60333	GEAR BOX ASSEMBLY
18	32100	1/4-20 HEX NUT ZINC	40	43020	BACKPLATE WASHER (FOR RT60)
19	32103	1/4-20 NYLON INS LOCKNUT ZINC	Optional	60060RNC	SIDE DEFLECTOR
20	36103	3/16 X 2" COTTER PIN S.S.	Optional	HEAVY DUTY RAIN COVER (F77080 for RT36 / F77130 for RT60)	
21	36104	3/16 X 1" COTTER PIN S.S.	Standard	12196RT	GAUGE OVERLAY- RT
22	33117	AGITATOR			



## STANDARD-OUTPUT PRO F13130D KIT

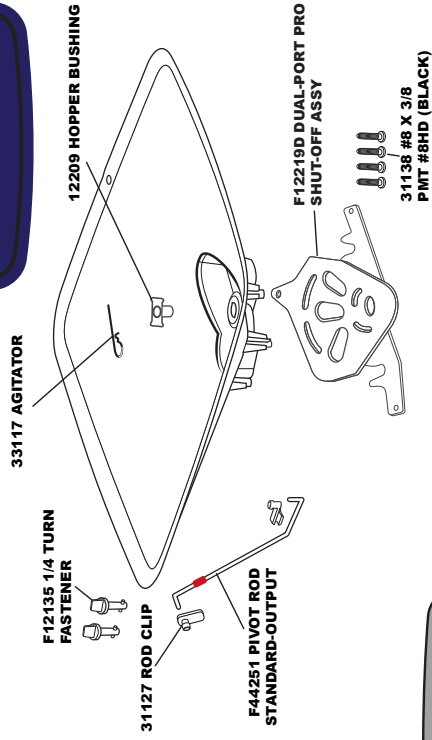
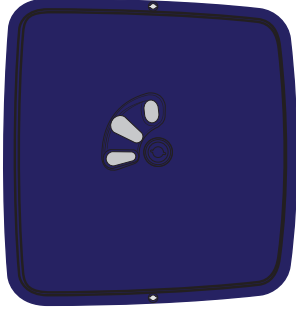

## LOW-OUTPUT F13130L

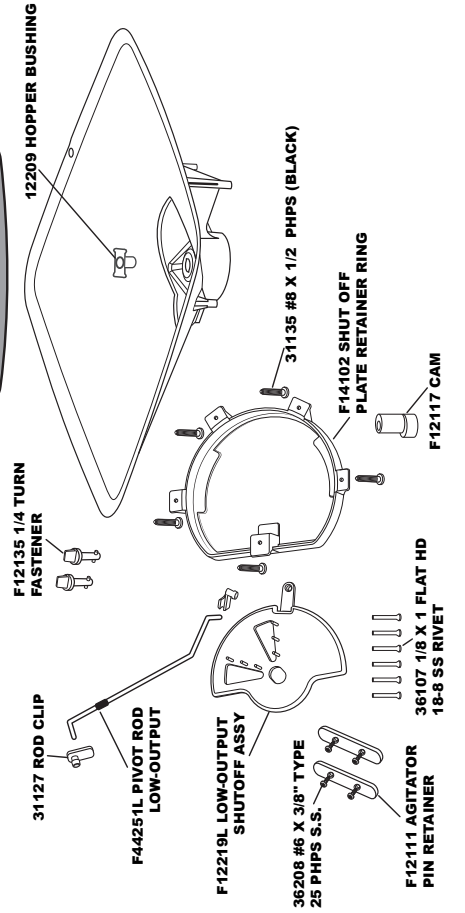
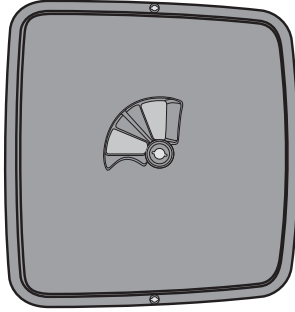

## HIGH-OUTPUT F13130H

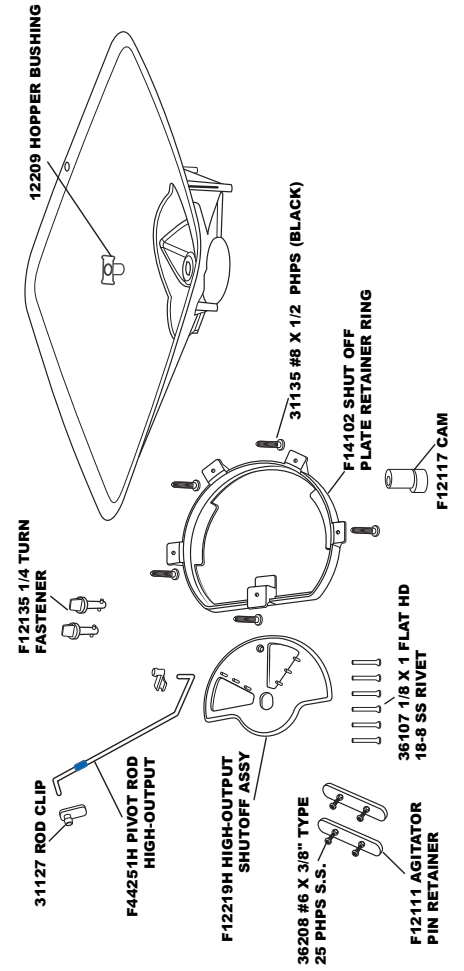
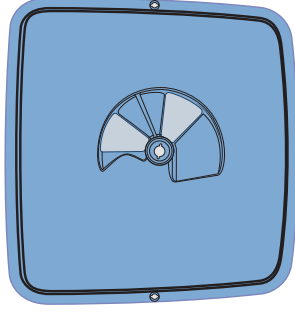





rigby taylor

Variations in physical characteristics of material applied, walking speed and surface roughness may require slightly different spreader settings. Due to the above conditions, the manufacturer makes no warranty as to the uniformity of coverage actually obtained from settings listed.

## OptiM8 BROADCAST SPREADER SETTING MATRIX

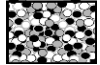
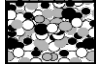
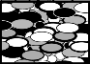
### GRANULAR MATERIAL



<b>Standard-Output Tray</b>				Mini				Maxi				EXTRA Maxi ROCK SALT			
PARTICLE SIZES: Fine (SAND)		SPREAD		SPREAD		SPREAD		SPREAD		SPREAD		SPREAD		SPREAD	
Grams PER Square Metre	SETTING	WIDTH FT	METRES	SETTING	WIDTH FT	METRES	SETTING	WIDTH FT	METRES	SETTING	WIDTH FT	METRES	SETTING	WIDTH FT	METRES
5	7	18	5.5	9	24	7.3	14	36	11.0	17	37	11.3			
10	10	18	5.5	13	24	7.3	18	36	11.0	22	37	11.3			
15	13	18	5.5	16	24	7.3	23	36	11.0	24	37	11.3			
20	14	18	5.5	20	24	7.3	27	36	11.0	26	37	11.3			
24	16	18	5.5	22	24	7.3	30	36	11.0	28	37	11.3			
29	18	18	5.5	25	24	7.3	23 x 2 pass	36	11.0	29	37	11.3			
34	20	18	5.5	27	24	7.3	25 x 2 pass	36	11.0	30	37	11.3			
39	22	18	5.5	28	24	7.3	27 x 2 pass	36	11.0	26 x 2 pass	37	11.3			
44	24	18	5.5	30	24	7.3	28 x 2 pass	36	11.0	27 x 2 pass	37	11.3			
49	26	18	5.5	22 x 2 pass	24	7.3	30 x 2 pass	36	11.0	28 x 2 pass	37	11.3			

### GRASS SEED

Grams PER Square Metre	FINE SETTING	SPREAD WIDTH FT	SPREAD METRES	COARSE SETTING	SPREAD WIDTH FT	SPREAD METRES
10	14	8	2.4	22	14	4.3
15	16	8	2.4	25	14	4.3
20	18	8	2.4	28	14	4.3
25	20	8	2.4	30	14	4.3

**Calibration:** Start by ensuring that your spreader calibration is correct. Make sure the drop holes in the **Standard-Output Tray** are fully open when the Rate Control handle is on #30. If not, please adjust control rod at the pivot to allow for a full open hopper holes with the handle at position at #30.

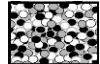
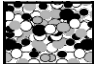
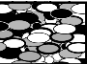
### GRANULAR MATERIAL



<b>Low-Output Black Tray</b>				Mini				Maxi				EXTRA Maxi ROCK SALT			
PARTICLE SIZES: Fine (SAND)		SPREAD		SPREAD		SPREAD		SPREAD		SPREAD		SPREAD		SPREAD	
Grams PER Square Metre	SETTING	WIDTH FT	METRES	SETTING	WIDTH FT	METRES	SETTING	WIDTH FT	METRES	SETTING	WIDTH FT	METRES	SETTING	WIDTH FT	METRES
5	8	16	4.9	10	20	6.1	15	30	9.1	18	24	7.3			
10	10	16	4.9	13	20	6.1	18	30	9.1	20	24	7.3			
15	12	16	4.9	18	20	6.1	23	30	9.1	25	24	7.3			
20	13	16	4.9	20	20	6.1	28	30	9.1	27	24	7.3			
24	16	16	4.9	22	20	6.1	30	30	9.1	30	24	7.3			
29	18	16	4.9	25	20	6.1	23 x 2 pass	30	9.1	25 x 2 pass	24	7.3			
34	20	16	4.9	27	20	6.1	25 x 2 pass	30	9.1	26 x 2 pass	24	7.3			
39	21	16	4.9	29	20	6.1	28 x 2 pass	30	9.1	27 x 2 pass	24	7.3			
44	23	16	4.9	30	20	6.1	29 x 2 pass	30	9.1	29 x 2 pass	24	7.3			
49	24	16	4.9	22 x 2 pass	20	6.1	30 x 2 pass	30	9.1	30 x 2 pass	24	7.3			

### GRASS SEED

Grams PER Square Metre	FINE SETTING	SPREAD WIDTH FT	SPREAD METRES	COARSE SETTING	SPREAD WIDTH FT	SPREAD METRES
10	15	9	2.7	21	15	4.6
15	18	9	2.7	24	15	4.6
20	21	9	2.7	27	15	4.6
25	24	9	2.7	30	15	4.6

**Calibration:** Start by ensuring that your spreader calibration is correct. Make sure the drop holes in the **LOW-OUTPUT TRAY** are fully closed when the Rate Control Handle is resting on the **stop #0**. If not, please adjust control rod at the pivot to ensure the shut-off is fully closed with the handle at position at #0. Move the spreader slightly to confirm the calibration because of the cam.

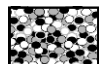
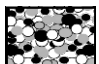
### GRANULAR MATERIAL

<b>High-Output Lt. Blue 2-hole Tray</b>				Mini				Maxi				EXTRA Maxi ROCK SALT			
PARTICLE SIZES: Fine (SAND)		SPREAD		SPREAD		SPREAD		SPREAD		SPREAD		SPREAD		SPREAD	
Grams PER Square Metre	SETTING	WIDTH FT	METRES	SETTING	WIDTH FT	METRES	SETTING	WIDTH FT	METRES	SETTING	WIDTH FT	METRES	SETTING	WIDTH FT	METRES
5	3	16	4.9	5	22	6.7	7	28	8.5	8	26	7.9			
10	5	16	4.9	6	22	6.7	10	28	8.5	11	26	7.9			
15	6	16	4.9	8	22	6.7	12	28	8.5	13	26	7.9			
20	7	16	4.9	9	22	6.7	14	28	8.5	14	26	7.9			
24	8	16	4.9	11	22	6.7	15	28	8.5	15	26	7.9			
29	10	16	4.9	13	22	6.7	17	28	8.5	16	26	7.9			
34	11	16	4.9	15	22	6.7	20	28	8.5	17	26	7.9			
39	12	16	4.9	16	22	6.7	21	28	8.5	18	26	7.9			
44	13	16	4.9	17	22	6.7	23	28	8.5	19	26	7.9			
49	14	16	4.9	18	22	6.7	24	28	8.5	21	26	7.9			

### GRASS SEED

Grams PER Square Metre	FINE SETTING	SPREAD WIDTH FT	SPREAD METRES	COARSE SETTING	SPREAD WIDTH FT	SPREAD METRES
10	7	10	3.0	11	15	4.6
15	9	10	3.0	14	15	4.6
20	11	10	3.0	16	15	4.6
25	13	10	3.0	18	15	4.6

**Calibration:** Start by ensuring that your spreader calibration is correct. Make sure the 2 drop holes in the **HIGH-OUTPUT TRAY** are fully closed when the Rate Control Handle is resting on the **stop #0**. If not, please adjust control rod at the pivot to ensure the shut-off is fully closed with the handle at position at #0. Move the spreader slightly to confirm the calibration because of the cam.